



THE LANESBOROUGH
LONDON

Meetings & Events



Welcome

Join us at The Lanesborough, enjoying the utterly English style of a vibrant and elegant Regency home where Hyde Park is your front garden, and the Household Cavalry pass by in an honourary salute. We invite you to host your meeting or private event amidst classic period elegance, mixing in some contemporary culture.

The Lanesborough Flair

There is much that distinguishes an exclusive and intimate event or meeting at The Lanesborough, our access, our location, our expertise, our wine cellar, gastronomy and of course our inherent elegance. Whether it is an important board meeting for ten or a spectacular dinner for 90, allow us to inspire you with some special Lanesborough flair.





Upper Ground Floor

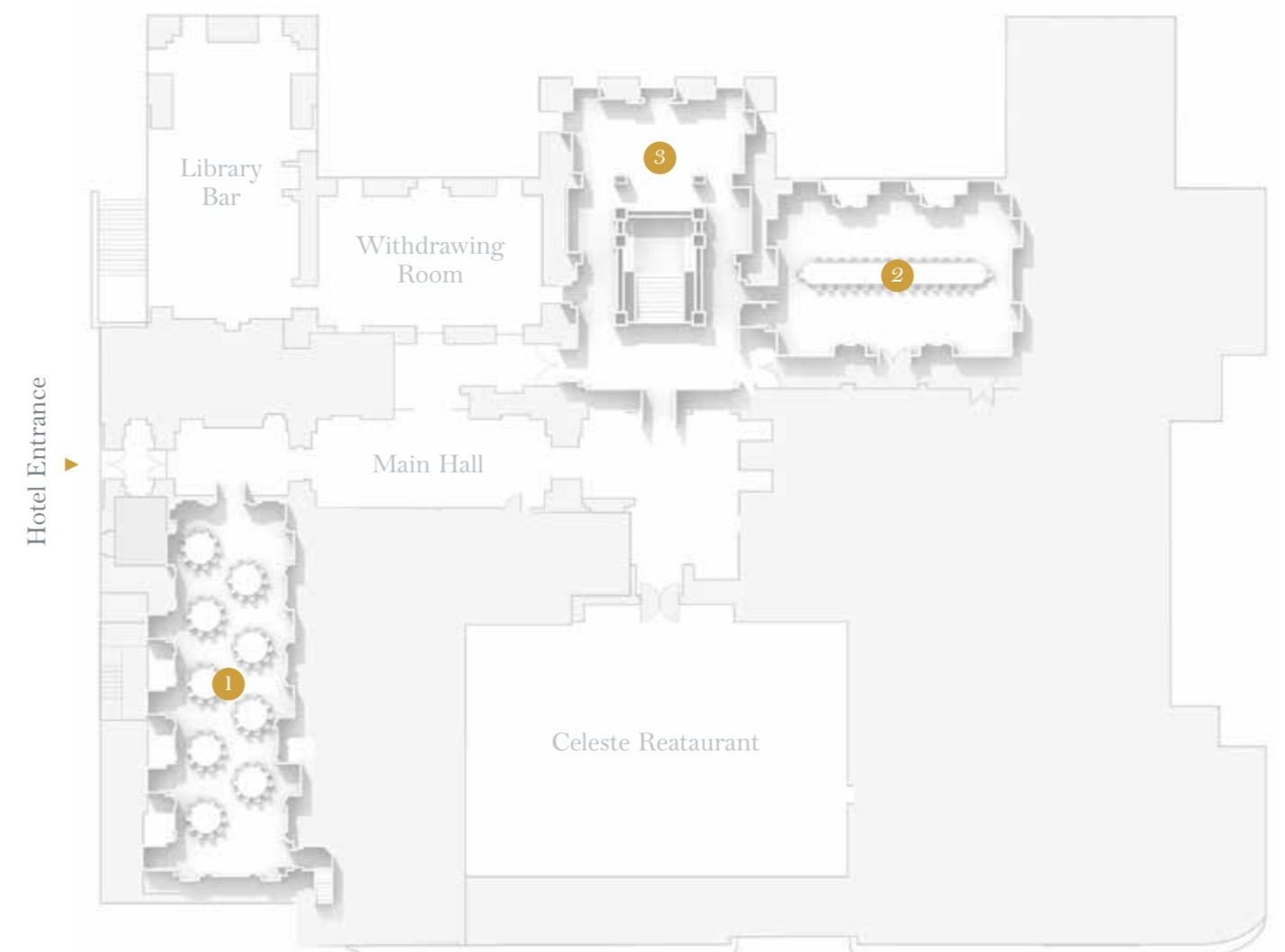

The beating heart of the hotel, the Upper Ground Floor features The Lanesborough's two largest spaces, The Belgravia and The St. George's, both flooded with natural daylight and accessed directly from the main hotel hall. Hand painted in lavish trompe l'oeil, the Great Hall is also located on this floor and is perfect for a welcome reception or cocktail party.

- 1 The Belgravia
- 2 The St. George's
- 3 The Great Hall





The Belgravia

								
LUNCH	DINNER	BOARDROOM	RECEPTION	OVAL	THEATER	U-SHAPE	CLASSROOM	CABARET
90	90	48	180	48	80	36	60	48

SPECIFICATION

Dimensions: 67 x 22 ft / 20 x 7 m
 Area: 1,487 ft² / 139 m²
 Ceiling Height: 12.5 ft / 4 m
 Daylight: Yes

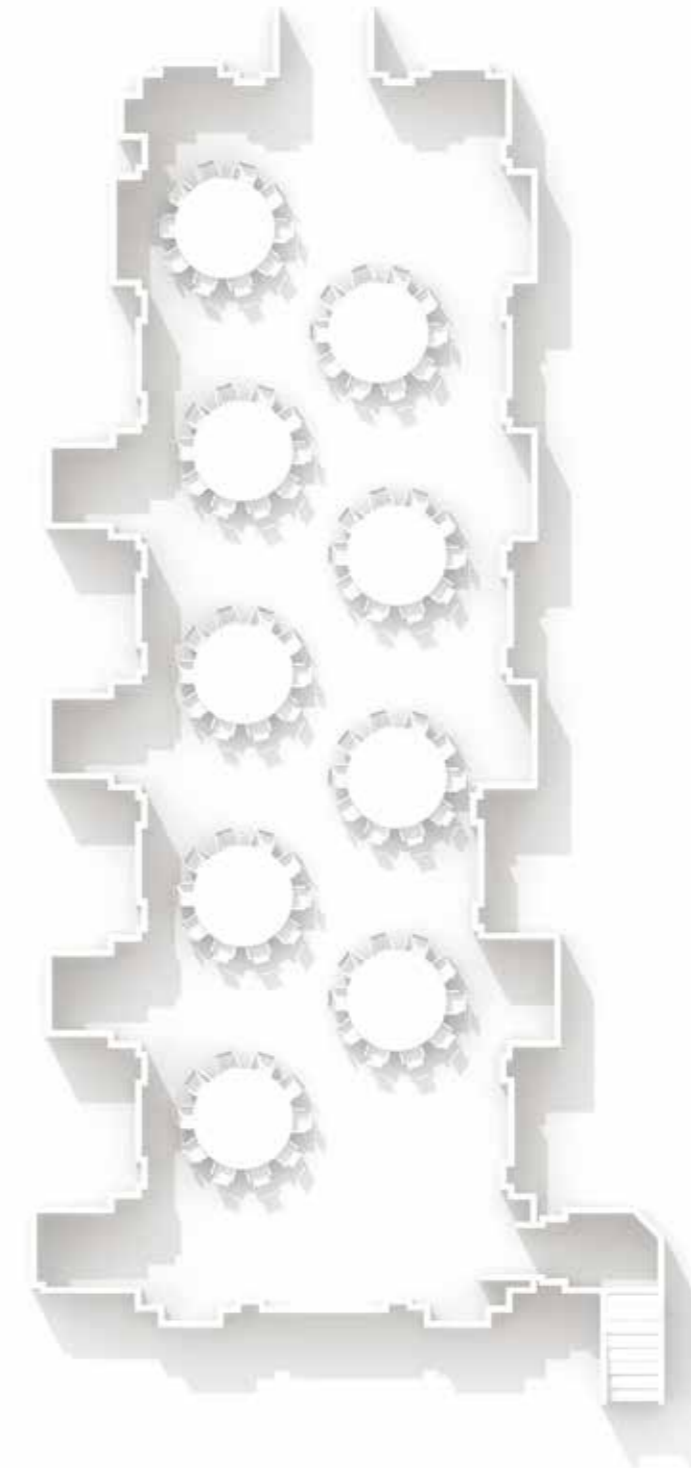

The Belgravia

The Belgravia is one of the finest formal meeting rooms in London, exquisitely designed and flooded with natural daylight.

The Belgravia features:

- Large Georgian period windows overlooking Hyde Park
 - Impressive cut-crystal chandeliers
 - High, hand-painted fresco ceilings
- A convenient location in the heart of the hotel.



The St. George

 LUNCH 50	 DINNER 50	 BOARDROOM 30	 RECEPTION 80	 OVAL 30	 THEATER 80	 U-SHAPE 26	 CLASSROOM 32	 CABARET 30
---	--	---	---	--	---	---	---	---

SPECIFICATION

Dimensions: 41 x 26 ft / 12 x 8 m
 Area: 1,064 ft² / 102 m²
 Ceiling Height: 12.5 ft / 4 m
 Daylight: Yes

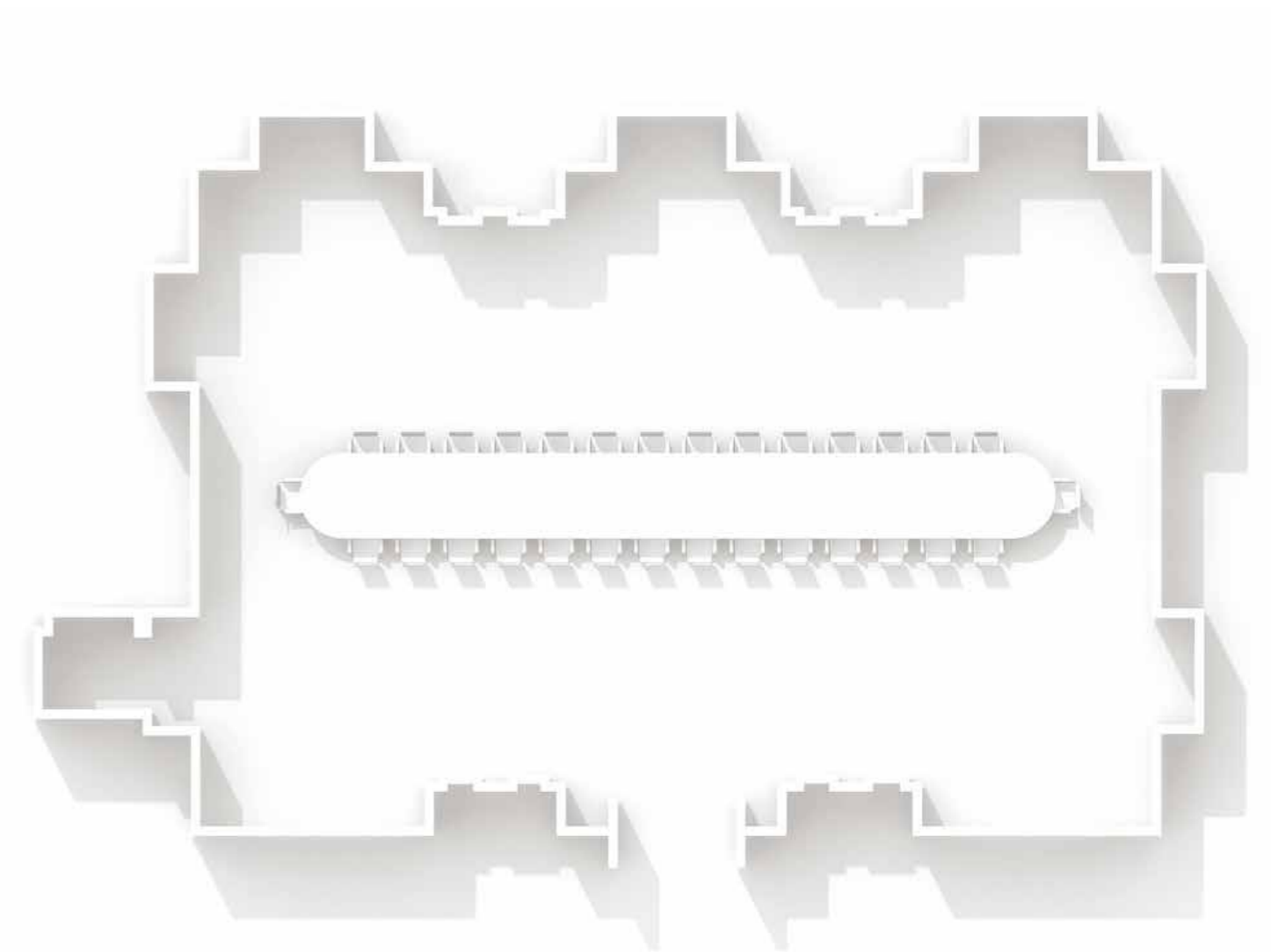

The St. George's

A warm, inviting and charismatic private meeting room,
 with a statesroom feel.

The St. George's features:

- Large Georgian period windows overlooking Wellington Arch
 - High ceilings with delicate gold-leaf detailing
 - Refined cut-crystal chandeliers
- Hand carved wood marquetry and a charming period fireplace.



The Great Hall

RECEPTION
100

SPECIFICATION

Ceiling Height: 12.5 ft / 4 m
Daylight: Yes

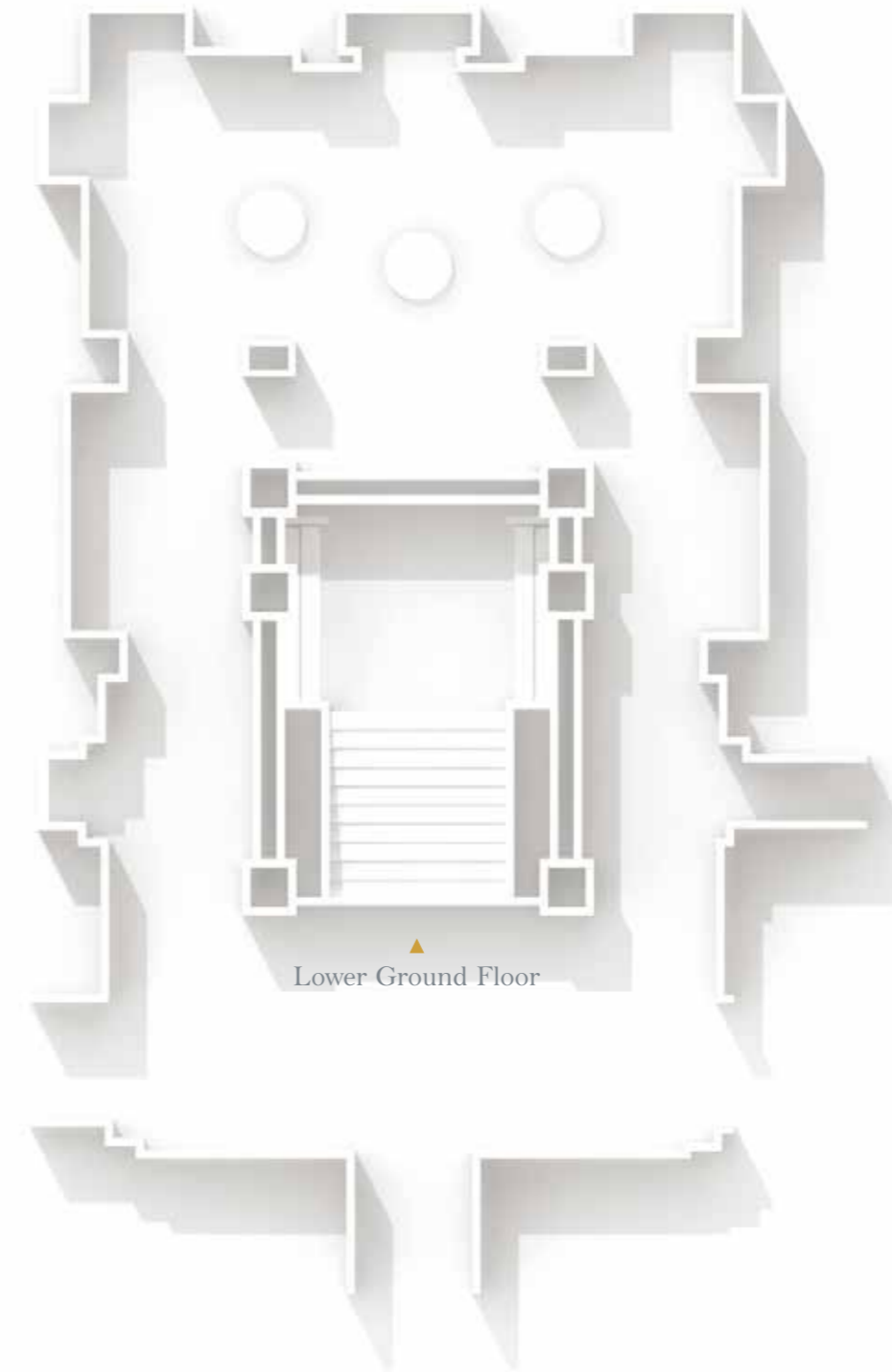

The Great Hall

The original entrance to the building and affectionately known as ‘The Queen’s entrance’. The Great Hall features incredible trompe-l’oeil wall painting, providing a magnificent semi-private backdrop for a welcome reception or glittering cocktail party.



Lower Ground Floor

The lower ground floor comprises five individual and unique meeting spaces with unique personalities, with The Westminster and The Wellington benefitting from natural daylight. The spaces are interconnected allowing for flexibility and a natural flow during events.

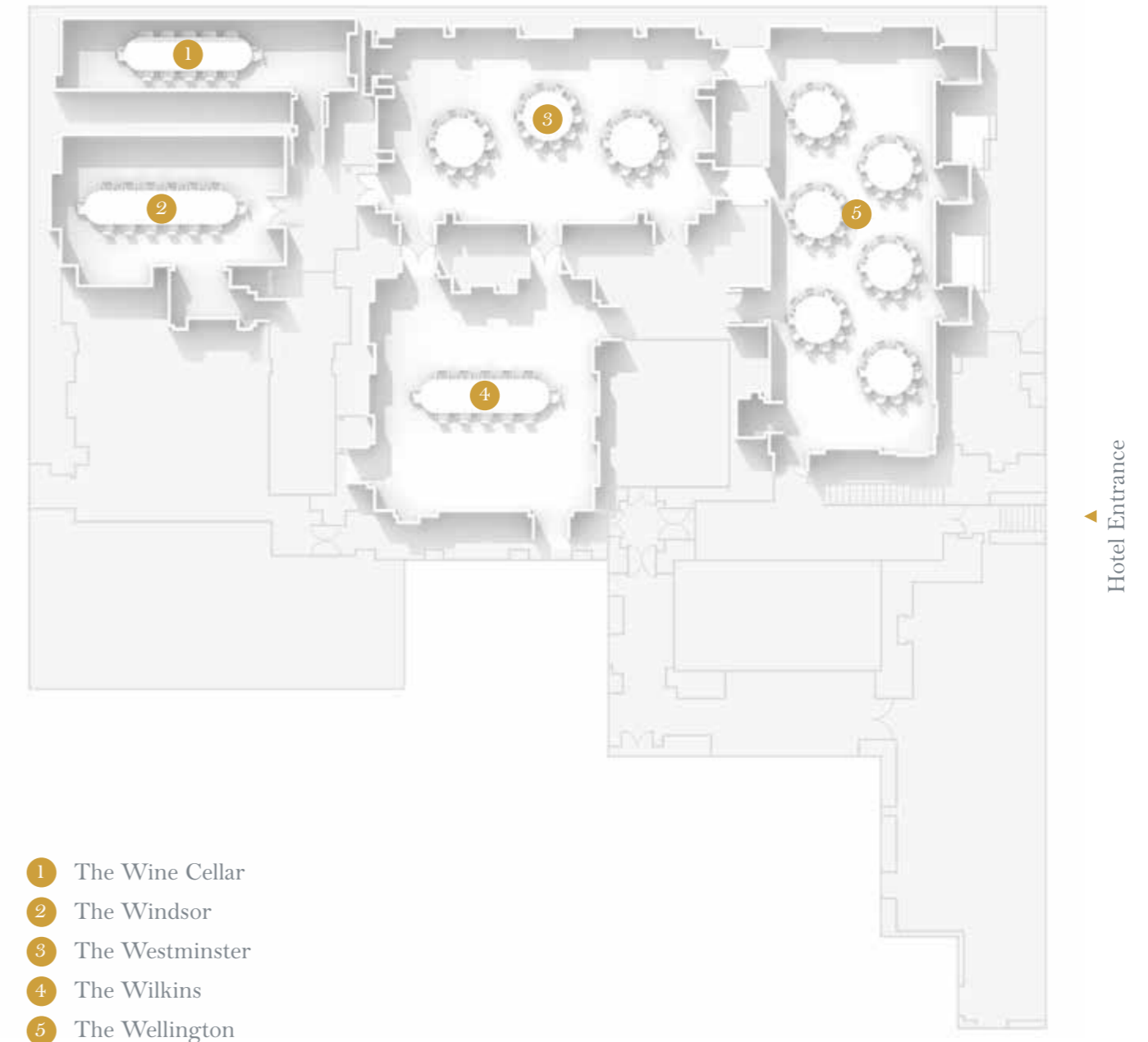



The Wine Cellar

 BOARDROOM
 12

 RECEPTION
 20

SPECIFICATION

Dimensions: 33 x 8 ft / 10 x 2 m
 Area: 256 ft² / 24 m²
 Ceiling Height: 10 ft / 3 m
 Maximum Guests: 12
 Daylight: No

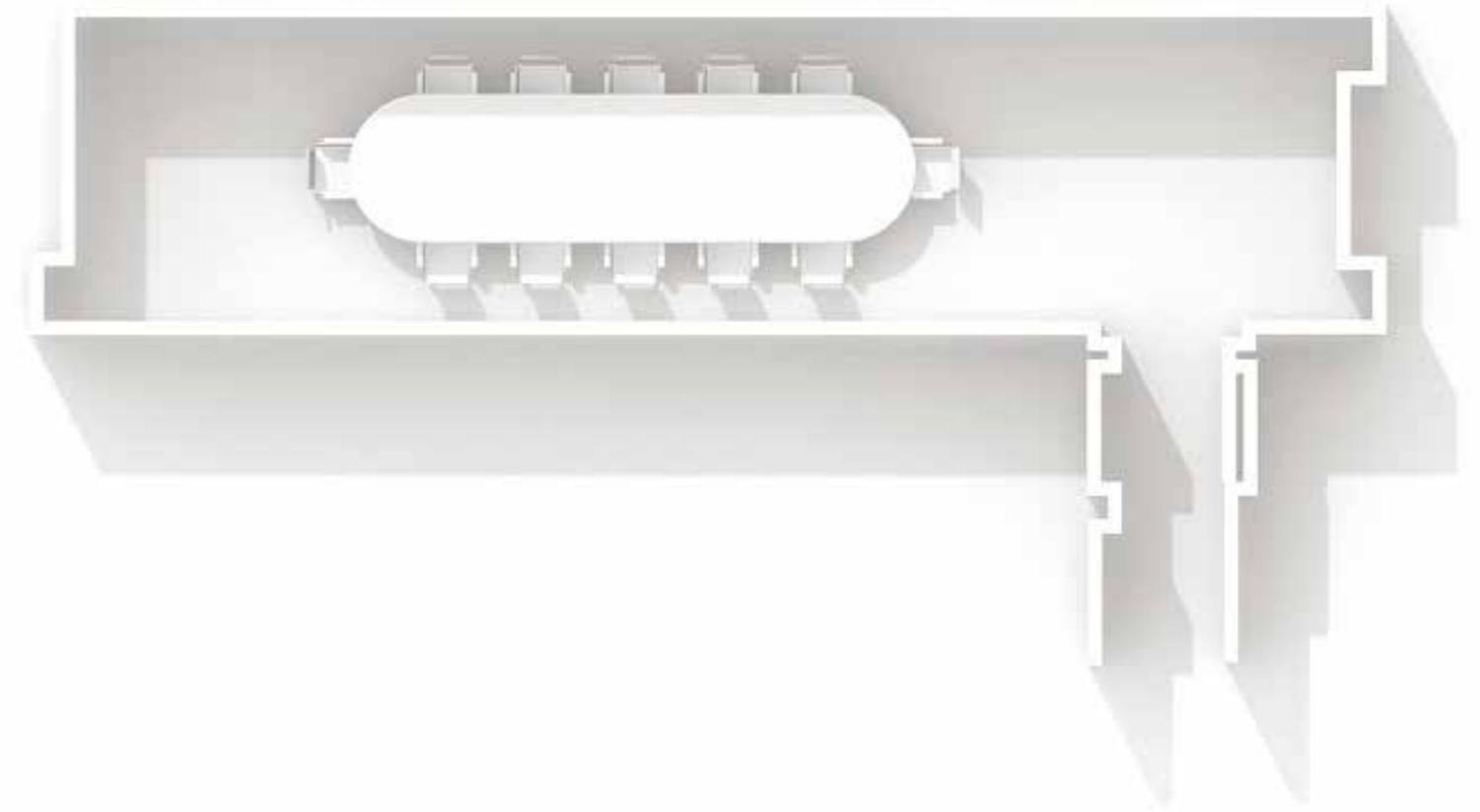

The Wine Cellar

Hosting a tasting event, or dinner, in The Lanesborough's intimate and atmospheric cellar is an historic experience in many different respects, especially when it involves the rarest of Cognac's from the Lanesborough's Liquid Paradis selection, dating back to 1770, and menus devised by Michelin-starred chef Steeven Gilles.



The Westminster

 LUNCH 30	 DINNER 30	 BOARDROOM 22	 RECEPTION 60	 OVAL 22	 THEATER 40	 U-SHAPE 20	 CLASSROOM 24	 CABARET 24
---	--	---	---	--	---	---	---	---

SPECIFICATION

Dimensions: 36 x 24 ft / 11 x 6.5 m
 Area: 769 ft² / 71 m²
 Ceiling Height: 12 ft / 2.45 m
 Daylight: Yes

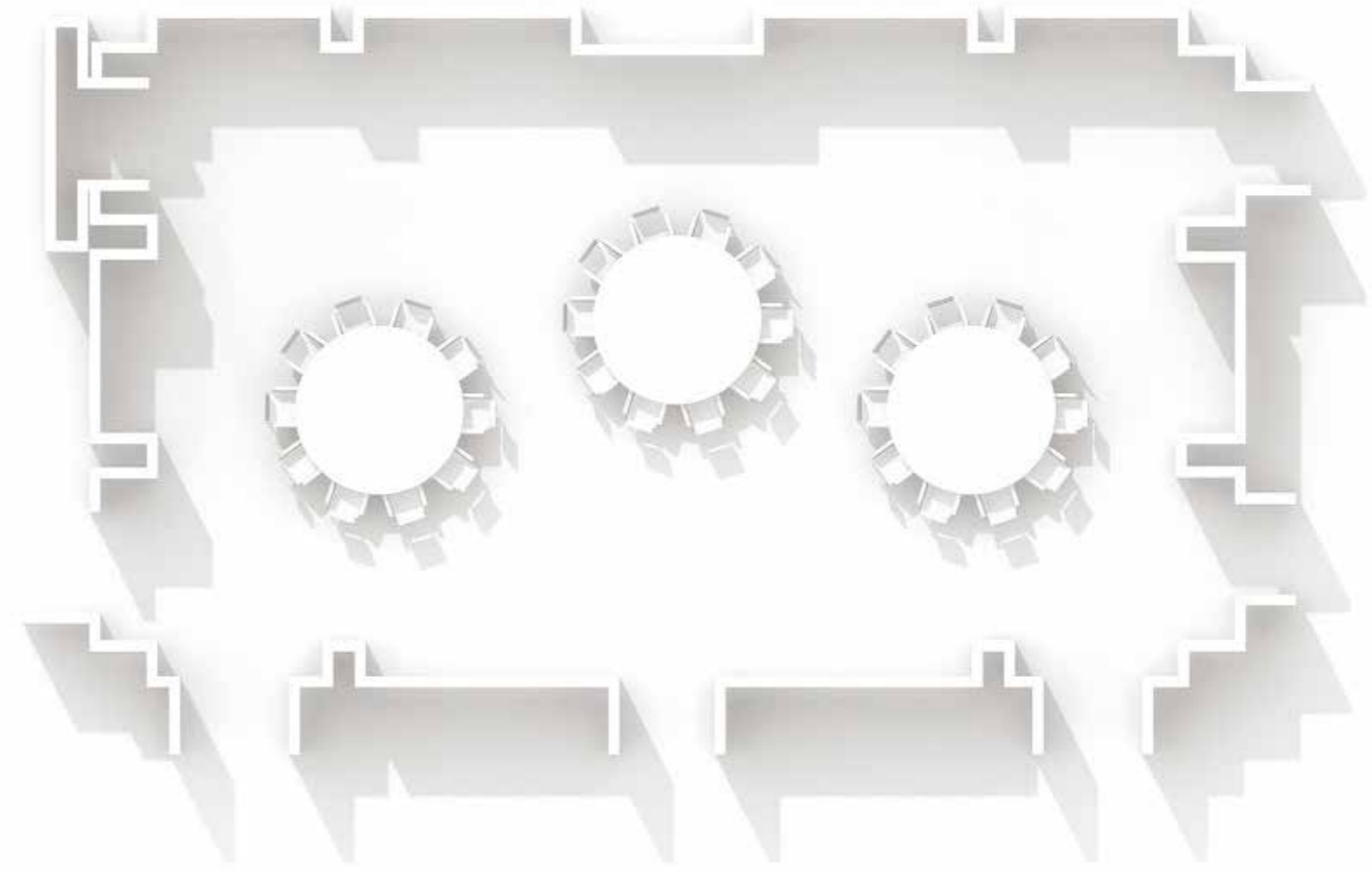

The Westminster

The Westminster Room offers another distinct contrast perfect for board meetings, receptions and glamorous dinners, with daylight flooding through the dramatic glass conservatory roof.

The Westminster features:

- A feature cut-crystal chandelier
- A glass roof creating a bright and airy atmosphere with natural daylight
- Delicate de Gournay wallcoverings
- Superb interconnectivity with the Wilkins and Wellington Rooms.



The Wilkins

								
LUNCH	DINNER	BOARDROOM	RECEPTION	OVAL	THEATER	U-SHAPE	CLASSROOM	CABARET
20	20	16	30	16	30	15	12	12

SPECIFICATION

Dimensions: 23 x 23 ft / 7 x 7 m
 Area: 543 ft² / 50 m²
 Ceiling Height: 8 ft / 2.15 m
 Daylight: No

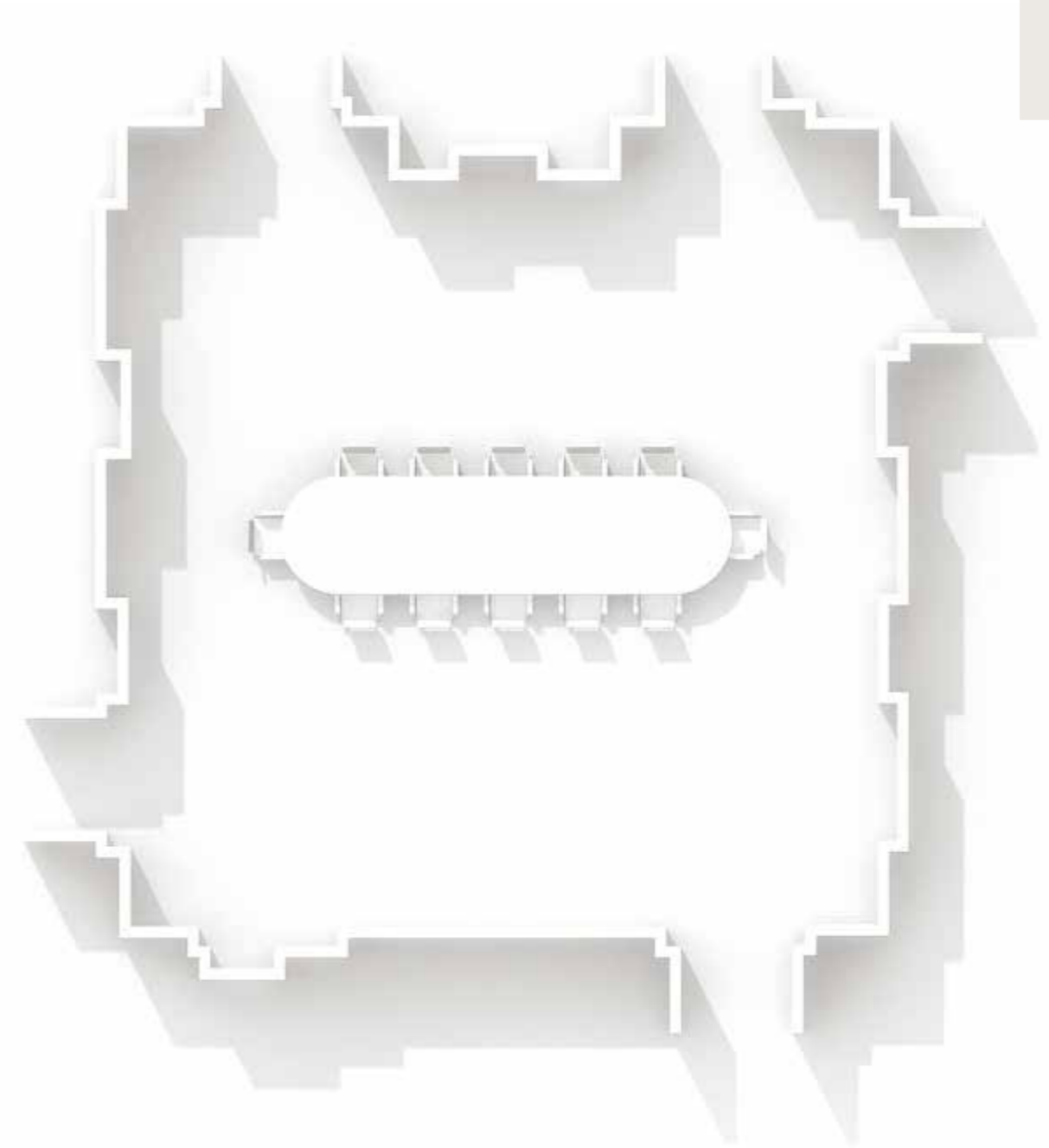

The Wilkins

Relief sculptures elegantly adorn the walls of The Wilkins, one of the three connecting rooms on the lower ground floor, which is ideal as an additional reception room, private meeting room or breakout area.

The Wilkins features:

- Built in flat screen television unit
- Interconnectivity with the Westminster and Wellington Rooms
- A private and discrete environment.



The Wellington

 LUNCH 60	 DINNER 60	 BOARDROOM 34	 RECEPTION 90	 OVAL 34	 THEATER 60	 U-SHAPE 36	 CLASSROOM 40	 CABARET 36
--	---	--	--	---	--	--	--	--

SPECIFICATION

Dimensions: 49 x 19 ft / 15 x 6 m
 Area: 954 ft² / 88 m²
 Ceiling Height: 8.5 ft / 3 m
 Daylight: Yes

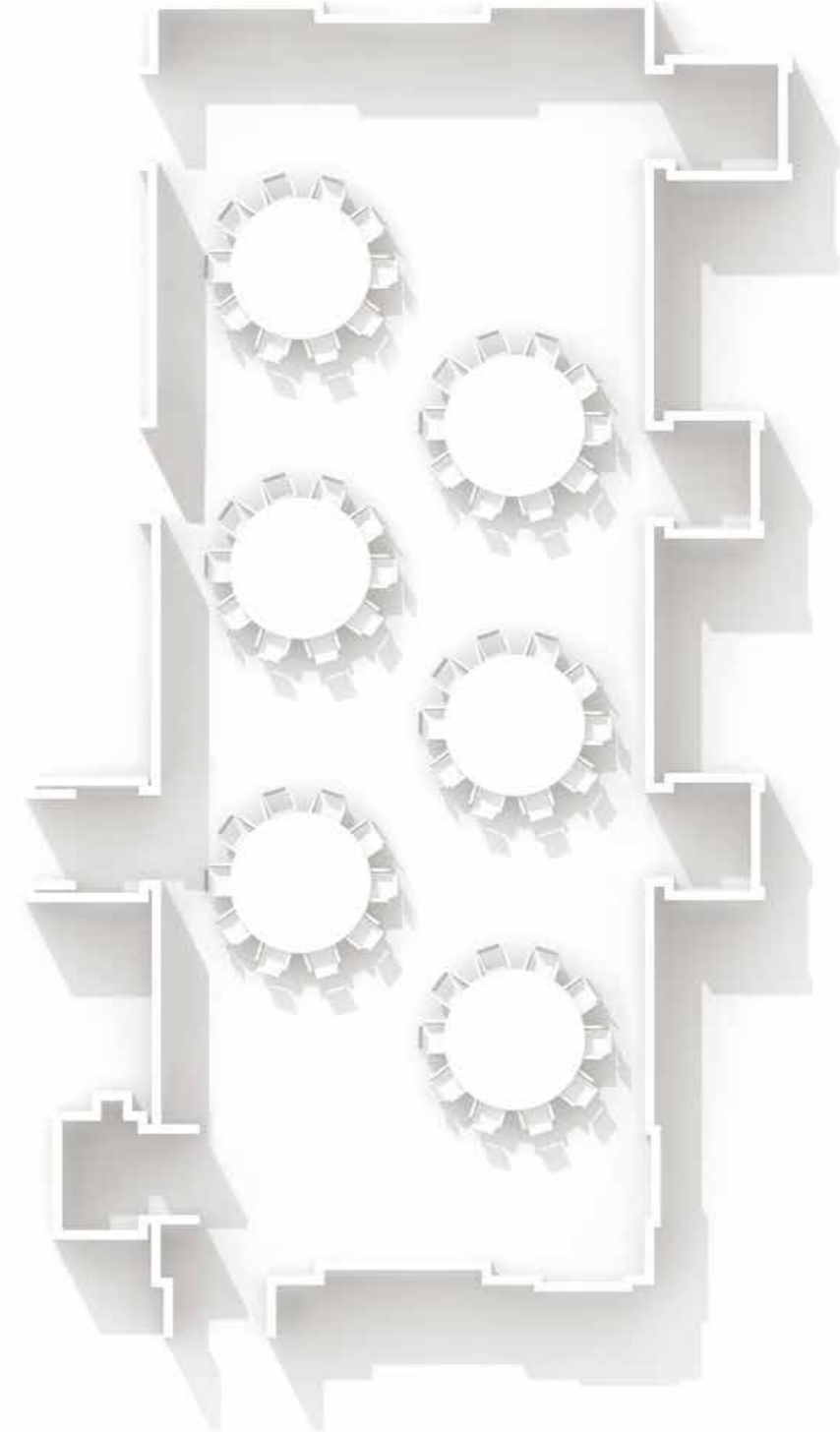

The Wellington

A Georgian fireplace makes a warm traditional setting for meetings and private events, with the space to host a variety of different events, from large board room to theatre style meetings.

The Wellington features:

- Natural daylight from four large windows
- A large and flexible meeting space
- Interconnectivity with the Westminster and Wilkins Rooms.



The Windsor

			
LUNCH	DINNER	BOARDROOM	OVAL
20	20	14	14

SPECIFICATION

Dimensions: 21 x 13 ft / 6.5 x 4 m
 Area: 264 ft² / 25 m²
 Ceiling Height: 9 ft / 3 m
 Daylight: No

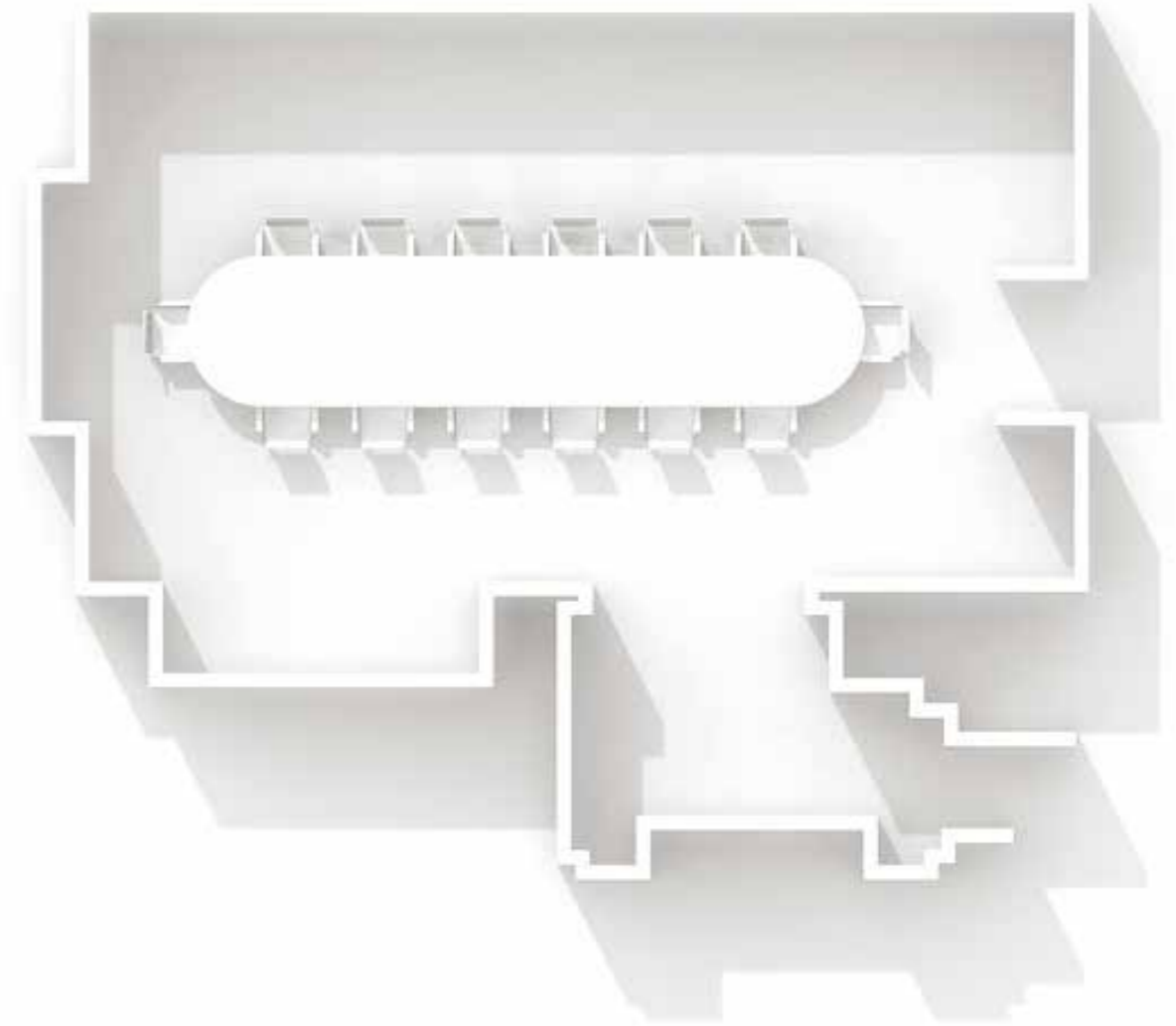



The Windsor

The Windsor is a classic boardroom, providing the ultimate privacy with timeless, neutral decoration.

The Windsor features:

- A built in flat screen plasma
- Superb location opposite to Westminster
- The ideal breakout space or private office area.

Room Capacities

	 Lunch	 Dinner	 Boardroom	 Reception	 Oval	 Theater	 U-Shape	 Classroom	 Cabaret
The Belgravia	90	90	48	180	48	80	36	60	48
The St. George	50	50	30	80	30	80	26	32	30
The Great Hall	-	-	-	100	-	-	-	-	-
The Wine Cellar	-	-	12	20	-	-	-	-	-
The Windsor	20	20	14	-	14	-	-	-	-
The Wellington	60	60	34	90	34	60	36	40	36
The Wilkins	20	20	16	30	16	30	15	12	12
The Westminster	30	30	22	60	22	40	20	24	24



Always a Gourmand Experience

With a la carte menus overseen by Michelin-starred Head Chef Steeven Gilles, and especially designed to allow for efficient and effortless service, the food at The Lanesborough is every bit as impressive as the stunning rooms. From exquisite daily delegate menus and elegant dinners to healthy breakfasts in collaboration with nutritional experts Bodyism, our talented chefs will create the perfect culinary experience for every occasion.





Gastronomic Britart

At The Lanesborough, each and every dish is a work of art, frequently eliciting an intake of breath upon presentation. Chef Patron Eric Frechon, is hailed as one of the greatest chefs in the world, with five Michelin stars between our sister hotel Le Bristol Paris and Céleste at The Lanesborough, where Executive Chef Steeven Gilles is the ‘artistic curator’ of gastronomy. Steeven seeks out the best ingredients, producers and suppliers the country has to offer and prepares exquisite and inventive creations with classic techniques.



The Lanesborough Fleet

Whilst you are having an event here, the entire The Lanesborough fleet is at your disposal. Our impeccable chauffeur-driven car service affords guests access to our famous Rolls-Royce Phantom with its extended wheelbase affording acres of space, Audi A8's and Mercedes S-Class models.

Exclusivity and Intimacy

The residential design and scale of The Lanesborough allows social events and weddings at the hotel to maintain an unparalleled level of exclusivity and intimacy, with private dining rooms and meeting spaces situated in the very heart of an iconic London institution.



Floristry

Our talented and highly skilled team of in-house floral designers is available to assist with all floral and design requirements, from opulent table pieces to refined room dressing.

Wine Pairings

Pierre-Marie Faure, head sommelier, will pair the perfect vintage with your menu, attending menu tastings to ensure an excellent match from The Lanesborough's extensive cellars. Private dinners and lunches can be elevated with a dynamic pairing, and our sommelier will make a selection of recommendations for each course.



The Lanesborough Club & Spa

With exclusive and industry leading treatments from La Prairie, ila and one of world's most impressive facial innovators, Anastasia Achilleos, the 20,000 ft² Club & Spa is the perfect haven for pre and post event pampering. Breath-taking in design and uncompromising in choice, guests can discover four single treatment rooms and one double treatment room, complete with Rasul and double shower, separate thermal suites for ladies and gentlemen, plus spacious changing rooms and a stunning hydro pool, serviced by Spa Butlers. Meanwhile the Painting Room provides an immaculate setting for the finishing touches to hands and toes.



Daniel Galvin Jr at The Lanesborough

Brides-to-be and guests wanting to look their very best during an event at The Lanesborough can visit the hotel's Daniel Galvin Jr Salon for a blow dry, styling or colouring. One of the world's leading colourists, and fourth generation hairdresser, Daniel Galvin Junior brings over 30 years of experience and a hand-picked team to his second salon in London, and is available by private appointment.

Rooms & Suites

Perfect for those attending an event or meeting, our 93 rooms, including 43 suites, are all stunningly furnished in the building's original Regency style: many with views over the neighbouring Royal Parks or towards Buckingham Palace. Special group rates are available for guests booking eight rooms or more.





THE LANESBOROUGH
LONDON



OETKER COLLECTION
Masterpiece Hotels

www.oetkercollection.com

The Lanesborough, Hyde Park Corner, London, SW1X 7TA T +44 (0)207 259 5599
www.lanesborough.com events@lanesborough.com